

Push Starlock Nut

Material: Hardened Carbon Steel

Class Grade: High Tensile Steel

Finish: Black Oxide

Corrosion Protection Level: Limited

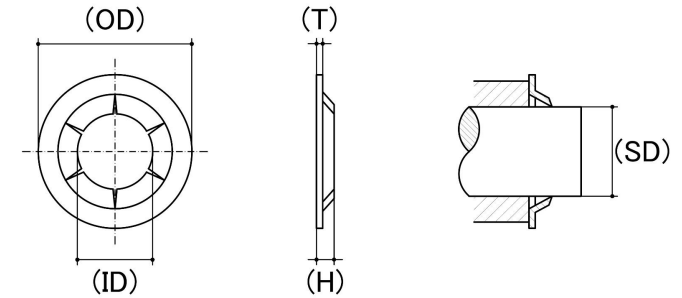

*CAD drawings shown for graphic representation only.**

| Size | Shaft Size (B) (mm) | Inside Dia. (ID) (mm) | Shaft Diameter (mm) | Outside Dimension (OD) (mm) | Thickness (T) (mm) | Unloaded Washer Height (H) (mm) | sku (qfind) |
|------|------------------------|--------------------------|------------------------|--------------------------------|-----------------------|------------------------------------|----------------|
| | Nom | Nom | Nom | Nom | Nom | Nom | |
| M2 | 2.00 | 1.90 | 2.00 | 6.00 | 0.27 | 0.60 | 37PN2BO |
| M2.6 | 2.60 | 2.40 | 2.60 | 7.00 | 0.30 | 0.90 | 37PN2.6BO |
| M3 | 3.00 | 2.85 | 3.00 | 9.90 | 0.35 | 1.37 | 37PN3BO |
| M4 | 4.00 | 3.85 | 4.00 | 11.80 | 0.35 | 1.42 | 37PN4BO |
| M5 | 5.00 | 4.95 | 5.00 | 13.80 | 0.40 | 1.55 | 37PN5BO |
| M6 | 6.00 | 5.95 | 6.00 | 15.80 | 0.40 | 1.80 | 37PN6BO |
| M8 | 8.00 | 7.95 | 8.00 | 17.50 | 0.50 | 1.80 | 37PN8BO |
| M10 | 10.00 | 9.95 | 10.00 | 20.80 | 0.70 | 2.25 | 37PN10BO |
| M12 | 12.00 | 11.95 | 12.00 | 27.00 | 0.87 | 2.85 | 37PNM12BO |
| M16 | 16.00 | 15.75 | 16.00 | 30.00 | 0.90 | 2.45 | 37PN16BO |

Disclaimer:

Dimensional data and technical information was obtained from publically available sources and not acquired through standard agencies. It has been completed and compiled for reference purposes only; where discrepancies are found they are subject to change without notice. Bolt & Nut Australia makes no warranties or representations regarding the accuracy and validity of the compiled information and data. Contact the relevant standard authorities for accurate and detailed information.

* CAD drawings may not reflect diameter, thread length or overall length.